

Motor Unit



User's manuals in other languages are available at :
<http://si.shimano.com>

IMPORTANT NOTICE

- Contact the place of purchase or a bicycle dealer for information on installation and adjustment of the products which are not found in the user's manual. A dealer's manual for professional and experienced bicycle mechanics is available on our website (<http://si.shimano.com>).
- Do not disassemble or alter this product.

For safety, be sure to read this user's manual thoroughly before use, and follow them for correct use.

Important Safety Information

Guidelines that require replacement, contact the place of purchase or a bicycle dealer.

⚠ WARNING

- After reading the user's manual carefully, keep it in a safe place for later reference.

Note

- This is a small waterproof connector. Do not repeat connecting and disconnecting it. It may impair the function.
- The components are designed to be fully waterproofed to withstand wet weather riding conditions; however, do not deliberately place them into water.
- Do not clean the bicycle in a high-pressure car wash. If water gets into any of the components, operating problems or rusting may result.
- Handle the products carefully, and avoid subjecting them to any strong shocks.
- Be careful not to let water get into the terminal.
- Do not use thinners or similar substances to clean the products. Such substances may damage the surfaces.
- Contact the place of purchase for updates of the product software. The most up-to-date information is available on the Shimano website.
- Products are not guaranteed against natural wear and deterioration from normal use and aging.
- For maximum performance we highly recommend Shimano lubricants and maintenance products.

This device complies with part 15 of the FCC Rules. Operation is subject to the following two conditions:
 (1) This device may not cause harmful interference, and (2) this device must accept any interference received, including interference that may cause undesired operation.

Regular inspections before riding the bicycle

Before riding the bicycle, check the following items. If any problems are found with the following items, contact the place of purchase or a bicycle dealer.

- Is there any noticeable damage to the electric wires?
- Is gear shifting carried out smoothly?
- Do any abnormal noises occur during operation?

Names of parts

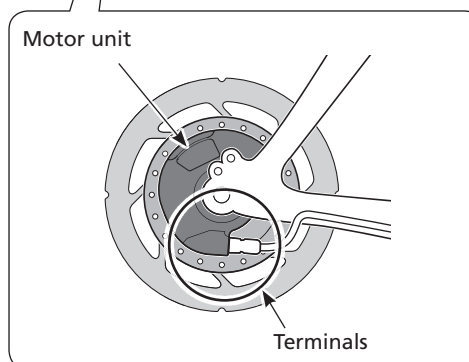

SHIMANO

SHIMANO NORTH AMERICA BICYCLE, INC.

One Holland, Irvine, California 92618, U.S.A. Phone: +1-949-951-5003

SHIMANO EUROPE B.V.

High Tech Campus 92, 5656 AG Eindhoven, The Netherlands Phone: +31-402-612222

SHIMANO INC.

3-77 Oimatsu-cho, Sakai-ku, Sakai-shi, Osaka 590-8577, Japan

Please note: specifications are subject to change for improvement without notice. (English)
 © Mar. 2018 by Shimano Inc. ITP

Internal Geared Hub 11-speed (Disc Brake)



User's manuals in other languages are available at :
<http://si.shimano.com>

IMPORTANT NOTICE

- Contact the place of purchase or a bicycle dealer for information on installation and adjustment of the products which are not found in the user's manual. A dealer's manual for professional and experienced bicycle mechanics is available on our website (<http://si.shimano.com>).
- Do not disassemble or alter this product.

For safety, be sure to read this user's manual thoroughly before use, and follow it for correct use.

Important Safety Information

For replacement information, contact the place of purchase or a bicycle dealer.

WARNING

- It is important to sufficiently understand the operation of the bicycle brake system. Improper use of your bicycle's brake system may result in a loss of control or a fall, which could lead to severe injury. Because each bicycle may handle differently, be sure to learn the proper braking technique (including brake lever pressure and bicycle control characteristics) and operation of your bicycle. This can be done by consulting your professional bicycle dealer and the bicycle's owners manual, and by practicing your riding and braking technique.
- Check that the wheels are fastened securely before riding the bicycle. If the wheels are loose in any way, they may come off the bicycle and serious injury may result.
- After reading the user's manual carefully, keep it in a safe place for later reference.

CAUTION

- Be sure to shift the shifting lever one or two gear at a time. During shifting, reduce the force being applied to the pedals. If you try to force operation of the shifting lever or perform multi-shifting while the pedals are being turned strongly, your feet may come off the pedals and the bicycle may topple over, which could result in serious injury. Operating the shifting lever to multi-shift to a light gear may also cause the outer casing to spring out of the shifting lever. This does not affect the capabilities of the shifting lever because the outer casing returns to the original position after shifting.

- If using a hydraulic disc brake, vapor lock may occur if the brakes are applied continuously. To relieve this condition, momentarily release the lever.

Vapor lock is a phenomenon in which the oil inside the brake system becomes heated, which causes any water or air bubbles inside the brake system to expand. This can then result in a sudden increase in the brake lever stroke.

- Spin the wheel and check the braking ability of the brake.
- If the brake is used frequently, the area around the brake may become hot. Do not touch the area around the brake for at least 30 minutes after riding the bicycle.

Area around the brake

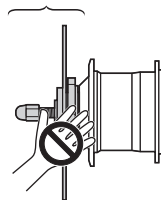

Note

- You can shift gears while pedaling, but on rare occasions the pawls and ratchet inside the hub may produce some noise afterwards as part of normal gear shifting operation.
- The 11-speed hub has a built-in mechanism to support shifting. When this support mechanism operates during shifting, noise or vibration may occur. The shifting may also feel different depending on the gear position. Noise may also be generated if the crank arms are turned backward or if the bicycle is pushed backward when the gear position is 7 – 11. These occurrences are a normal result of the structure of the internal gear shifting mechanism, and are not a sign of a malfunction.
- The bolt on the hub shell is the bolt used when changing the oil. Never loosen this bolt except to change the oil. Doing so may cause oil to leak out, resulting in splashing.
- In order to maintain proper performance, it is recommended that you contact the place of purchase or a bicycle dealer to carry out maintenance such as internal oil replacement after riding 1,000 km from the start of use and after that, about once every two years (or once about every 5,000 km if the bicycle is used very frequently).

- The internal hub is not completely waterproof. Avoid using the hub in places where water might get inside and do not use high-pressure water to clean the hub, otherwise the internal mechanism may rust.
- The chainrings should be periodically washed with a neutral detergent. In addition, cleaning the chain with neutral detergent and lubricating it can be an effective way of extending the life of the chainrings and the chain.
- If the chain has started skipping, replace the gears and the chain at a dealer or an agency.
- Products are not guaranteed against natural wear and deterioration from normal use and aging.
- For maximum performance we highly recommend Shimano lubricants and maintenance products.

Regular inspections before riding the bicycle

Before riding the bicycle, check the following items. If any problems are found with the following items, contact the place of purchase or a bicycle dealer.

- Is gear shifting carried out smoothly?
- Are the setting lines of the cassette joint in the correct position?
- Do any abnormal noises occur during operation?
- * For information on how to inspect the shifting cable adjustment, refer to the user's manual for the shifting lever.

Names of parts

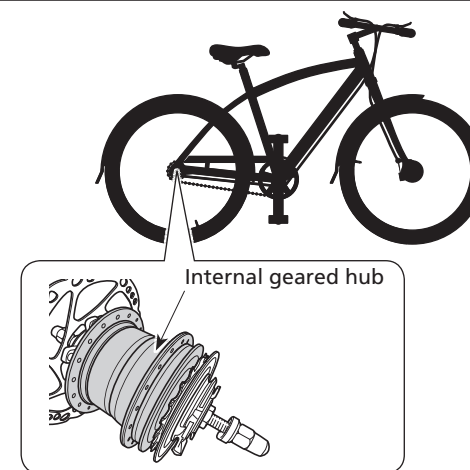

SHIMANO

SHIMANO AMERICAN CORPORATION
One Holland, Irvine, California 92618, U.S.A. Phone: +1-949-951-5003

SHIMANO EUROPE B.V. SHIMANO INC.
High Tech Campus 92, 5656 AG Eindhoven, The Netherlands Phone: +31-402-612222 3-77 Oimatsu-cho, Sakai-ku, Sakai-shi, Osaka 590-8577, Japan

Please note: specifications are subject to change for improvement without notice. (English)
© Dec. 2016 by Shimano Inc. ITP

Switch Unit



User's manuals in other languages are available at :
<http://si.shimano.com>

IMPORTANT NOTICE

- Contact the place of purchase or a bicycle dealer for information on installation and adjustment of the products which are not found in the user's manual. A dealer's manual for professional and experienced bicycle mechanics is available on our website (<http://si.shimano.com>).
- Do not disassemble or alter this product.

For safety, be sure to read this user's manual thoroughly before use, and follow it for correct use.

Important Safety Information

For replacement information, contact the place of purchase or a bicycle dealer.

WARNING

- After reading the user's manual carefully, keep it in a safe place for later reference.

Note

- This is a small waterproof connector. Do not keep connecting and disconnecting the small waterproof connector. It may impair the function.
- The components are designed to be fully waterproof and withstand wet weather riding conditions; however, do not deliberately place them into water.
- Do not clean the bicycle in a high-pressure car wash. If water gets into any of the components, operating problems or rusting may result.
- Handle the products carefully, and avoid subjecting them to strong shock.
- Be careful not to let water get into the E-TUBE port.
- Do not use thinners or similar substances to clean the products. Such substances may damage the surfaces.
- Contact the place of purchase for updates of the product software. The most up-to-date information is available on the Shimano website.
- Products are not guaranteed against natural wear and deterioration from normal use and aging.
- For maximum performance we highly recommend Shimano lubricants and maintenance products.

This device complies with part 15 of the FCC Rules. Operation is subject to the following two conditions:
 (1) This device may not cause harmful interference, and (2) this device must accept any interference received, including interference that may cause undesired operation.

Regular inspections before riding the bicycle

Before riding the bicycle, check the following items. If any problems are found with the following items, contact the place of purchase or a bicycle dealer.

- Can it be operated smoothly?
- Is the switch unit securely attached to the handlebar?
- Do any abnormal noises occur during operation?

Names of parts

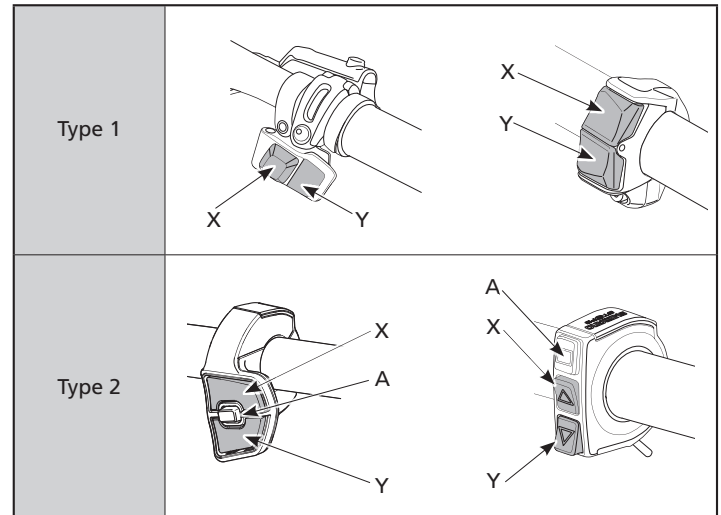

Switch functions

Switch	Function assignment	Operation
X	Gear shifting	Shifts up each time pressed.
	Assist	Increases assist strength each time pressed.
Y	Gear shifting	Shifts down each time pressed.
	Assist	Decreases assist strength each time pressed.
A	Gear shifting mode switch	Switches between auto and manual gear shifting.
	Display switch	Switches the cycle computer display.

- Default values are listed above. The functions assigned to each switch can be changed.
- Actual behavior may differ depending on the connected components and software version.
- Depending on the model used, settings may need to be changed before use.
- When used as a shifting switch, it can be set to multi shift mode (which shifts between multiple gears) by holding the button down.
- For change of the switch unit setting, ask the shop where purchased.

SHIMANO

SHIMANO NORTH AMERICA BICYCLE, INC.

One Holland, Irvine, California 92618, U.S.A. Phone: +1-949-951-5003

SHIMANO EUROPE B.V.

High Tech Campus 92, 5656 AG Eindhoven, The Netherlands Phone: +31-402-612222

SHIMANO INC.

3-77 Oimatsu-cho, Sakai-ku, Sakai-shi, Osaka 590-8577, Japan

Please note: specifications are subject to change for improvement without notice. (English)
 © Mar. 2018 by Shimano Inc. ITP